

## S115A STARTER MOTOR SERIES

MODEL TYPE 12 VOLT	PART NO:	PINION ASSY QTY 1 [ 1 ]	OIL SEAL QTY 1 [ 4 ]	D.E. HSG ASSY QTY 1 [ 6 ]	MAIN TERMINAL QTY 1 [ 17 ]	LOCKING WASHER QTY 2 [ 27 ]	LUCAR TERMINAL QTY 1 [ 27A ]	NUT QTY 2 [ 28 ]	WASHER QTY 1 [ 29 ]	WASHER QTY 1 [ 30 ]	TERMINAL QTY [ ] [ 32 ]	INSULATING BUSH QTY 1 [ 34A ]	INSULATING BUSH QTY [ ] [ 34D ]
S115A-12-1	1327A011	6211-700B	-	6510-39K	6510-4	5001-74	6211-616A	NU11-5T1	5936-482J	NW2-283T1	6211-820 [1]	-	5587-183 [1]
S115A-12-3M	1327A021	6211-700V	6211-221	6510-39L	6510-4	5001-74	-	NU11-5T1	5936-482J	NW2-283T1	6211-820 [2]	6211-821A	5587-183 [2]
S115A-12-3	1327A024	6211-700B	-	6510-39L	6510-4	5001-74	-	NU11-5T1	5936-482J	NW2-283T1	6211-820 [2]	6211-821A	5587-183 [2]
S115A-12-4M	1327A031	6211-700V	6211-221	6510-39M	6510-4	5001-74	-	NU11-5T1	5936-482J	NW2-283T1	6211-820 [1]	6211-821A	5587-183 [1]
S115A-12-5	1327A041	6211-700B	-	6510-39N	6510-4	5001-74	6211-616A	NU11-5T1	5936-482J	NW2-283T1	6211-820 [1]	-	5587-183 [1]
S115A-12-7	1327A051	6211-700B	-	6510-39P	6510-4	5001-74	6211-616A	NU11-5T1	5936-482J	NW2-283T1	6211-820 [1]	-	5587-183 [1]
S115A-12-9	1327A061	6211-700B	-	6510-39H	6510-4	5001-74	-	NU11-5T1	5936-482J	NW2-283T1	6211-820 [1]	-	5587-183 [1]
S115A-12-10	1327A071	6211-700W	6211-221	6510-39H	6510-4	5001-74	-	NU11-5T1	5936-482J	NW2-283T1	6211-820 [1]	-	5587-183 [1]
S115A-12-11M	1327A081	6211-700AC	6211-221	6510-39Q	6510-4	5001-74	-	NU11-5T1	5936-482J	NW2-283T1	6211-820 [2]	6211-821A	5587-183 [2]
S115A-12-12	1327A091	6211-700W	6211-221	6510-39K	6510-4	5001-74	-	NU11-5T1	5936-482J	NW2-283T1	6211-820 [1]	-	5587-183 [1]
S115A-12-13M	1327A101	6211-700AD	6211-221	6510-39L	6510-4	5001-74	-	NU11-5T1	5936-482J	NW2-283T1	6211-820 [2]	6211-821A	5587-183 [2]
S115A-12-14	1327A111	6211-700T	-	6510-39K	6510-4	5001-74	-	NU11-5T1	5936-482J	NW2-283T1	6211-820 [1]	-	5587-183 [1]
S115A-12-15M	1327A121	6211-700AD	6211-221	6510-39L	6510-4	5001-74	-	NU11-5T1	5936-482J	NW2-283T1	6211-820 [2]	6211-821A	5587-183 [2]
S115A-12-30M	1327A141	6211-700AL	6211-221	6510-39V	6510-3	5001-26	-	NU11-7T1	5936-482J	5936-482B	6211-820 [2]	6211-821A	5587-183 [2]

MODEL TYPE 24 VOLT	PART NO:	PINION ASSY QTY 1 [ 1 ]	OIL SEAL QTY 1 [ 4 ]	D.E. HSG ASSY QTY 1 [ 6 ]	MAIN TERMINAL QTY 1 [ 17 ]	LOCKING WASHER QTY 2 [ 27 ]	LUCAR TERMINAL QTY 1 [ 27A ]	NUT QTY 2 [ 28 ]	WASHER QTY [ ] [ 29 ]	WASHER QTY 1 [ 30 ]	TERMINAL QTY [ ] [ 32 ]	INSULATING BUSH QTY 1 [ 34A ]	INSULATING BUSH QTY [ ] [ 34D ]
S115A-24-1	1327A 411	6211-700B	-	6510-39A	6510-4	5001-74	6211-616A	NU11-5T1	5936-482J [1]	NW2-283T1	6211-820 [1]	6211-821A	5587-183 [1]
S115A-24-2	1327A 421	6211-700B	-	6510-39	6510-4	5001-74	6211-616A	NU11-5T1	5936-482J [1]	NW2-283T1	6211-820 [1]	6211-821A	5587-183 [1]
S115A-24-3M	1327A 431	6211-700V	6211-221	6510-39B	6510-4	5001-74	-	NU11-5T1	5936-482J [1]	NW2-283T1	6211-820 [2]	6211-821A	5587-183 [2]
S115A-24-3	1327A 434	6211-700B	-	6510-39B	6510-4	5001-74	-	NU11-5T1	5936-482J [1]	NW2-283T1	6211-820 [2]	-	5587-183 [2]
S115A-24-4M	1327A 441	6211-700V	6211-221	6510-39C	6510-4	5001-74	-	NU11-5T1	5936-482J [1]	NW2-283T1	6211-820 [2]	6211-821A	5587-183 [2]
S115A-24-5	1327A 451	6211-700B	-	6510-39D	6510-4	5001-74	6211-616A	NU11-5T1	5936-482J [1]	NW2-283T1	6211-820 [1]	6211-821A	5587-183 [1]
S115A-24-6	1327A 461	6211-700E	-	6510-39E	6510-4	5001-74	-	NU11-5T1	5936-482J [1]	NW2-283T1	6211-820 [2]	6211-821A	5587-183 [2]
S115A-24-7	1327A 471	6211-700B	-	6510-39F	6510-4	5001-74	6211-616A	NU11-5T1	5936-482J [1]	NW2-283T1	6211-820 [1]	6211-821A	5587-183 [1]
S115A-24-8	1327A 481	6211-700B	-	6510-39E	6510-4	5001-74	6211-616A	NU11-5T1	5936-482J [1]	NW2-283T1	6211-820 [2]	6211-821A	5587-183 [2]
S115A-24-9	1327A 491	6211-700B	-	6510-39G	6510-4	5001-74	-	NU11-5T1	5936-482J [1]	NW2-283T1	6211-820 [1]	6211-821A	5587-183 [1]
S115A-24-11M	1327A 501	6211-700AC	6211-221	6510-39J	6510-4	5001-74	-	NU11-5T1	5936-482J [1]	NW2-283T1	6211-820 [2]	6211-821A	5587-183 [2]
S115A-24-12	1327A 511	6211-700W	6211-221	6510-39A	6510-4	5001-74	-	NU11-5T1	5936-482J [1]	NW2-283T1	6211-820 [1]	-	5587-183 [1]
S115A-24-13M	1327A 521	6211-700AD	6211-221	6510-39B	6510-4	5001-74	-	NU11-5T1	5936-482J [1]	NW2-283T1	6211-820 [2]	6211-821A	5587-183 [2]
S115A-24-14	1327A 531	6211-700T	-	6510-39A	6510-4	5001-74	-	NU11-5T1	5936-482J [1]	NW2-283T1	6211-820 [1]	6211-821A	5587-183 [1]
S115A-24-15M	1327A 541	6211-700D	6211-221	6510-39B	6510-4	5001-74	-	NU11-5T1	5936-482J [1]	NW2-283T1	6211-820 [2]	6211-821A	5587-183 [2]
S115A-24-16M	1327A 551	6211-700V	6211-221	6510-39B	6510-4	5001-74	-	NU11-5T1	5936-482J [1]	NW2-283T1	6211-820 [2]	6211-821A	5587-183 [2]
S115A-24-18	1327A 571	6211-700AB	-	6510-39B	6510-4	5001-74	-	NU11-5T1	5936-482J [1]	NW2-283T1	6211-820 [1]	-	5587-183 [1]
S115A-24-19	1327A 581	6211-700E	-	6510-39S	6510-4	5001-74	6211-616A	NU11-5T1	5936-482J [1]	NW2-283T1	6211-820 [1]	6211-821A	5587-183 [1]
S115A-24-20	1327A 591	6211-700B	-	6510-39Z	6510-4	5001-74	6211-616A	NU11-5T1	5936-482J [1]	NW2-283T1	6211-820 [2]	6211-821A	5587-183 [2]
S115A-24-21	1327A 601	6211-700N	-	6510-39A	6510-3	5001-26	-	NU11-7T1	5936-482J [1]	5936-482B	6211-819 [1]	-	5587-183 [1]
S115A-24-22	1327A 611	6211-700E	-	6510-39Y	6510-4	5001-74	-	NU11-5T1	5936-482J [1]	NW2-283T1	6211-820 [2]	6211-821A	5587-183 [2]
S115A-24-23	1327A 621	6211-700W	6211-221	6510-39F	6510-4	5001-74	6211-616A	NU11-5T1	5936-482J [1]	NW2-283T1	6211-820 [1]	6211-821A	5587-183 [1]
S115A-24-25	1327A 641	6211-700N	-	6510-39T	6510-3	5001-26	-	NU11-7T1	5936-482J [1]	5936-482B	6211-819 [1]	-	5587-183 [1]
S115A-24-27	1327A 661	6211-700N	-	6510-39A	6510-3	5001-26	-	NU11-7T1	5936-482J [1]	5936-482B	6211-819 [1]	-	5587-183 [1]
S115A-24-28	1327A 671	6211-700N	-	6510-39A	6510-3	5001-26	-	NU11-7T1	5936-482J [1]	5936-482B	6211-819 [1]	-	5587-183 [1]
S115A-24-29	1327A 681	6211-964	-	6510-39U	6510-2	5001-43	-	NU11-10T1	5936-482J [2]	-	6211-819 [1]	-	5587-183 [1]
S115A-24-30M	1327A 691	6211-700AL	6211-221	6510-39W	6510-3	5001-26	6220-86A	NU11-7T1	5936-482J [1]	5936-482B	6211-820 [2]	6211-821A	5587-183 [2]
S115A-24-32	1327A 700	6211-700AM	-	6510-39AA	6510-4	5001-74	-	NU11-5T1	5936-482J [1]	NW2-283T1	6211-820 [1]	6211-821A	5587-183 [1]
S115A-24-33	1327A 710	6211-700E	-	6510-39S	6510-4	5001-74	-	NU11-5T1	5936-482J [1]	NW2-283T1	6211-820 [1]	6211-821A	5587-183 [1]

## S115A STARTER MOTOR SERIES

MODEL TYPE 12 VOLT	PART NO:	"O" RING SEAL QTY [ ] [ 34E ]	INSULATING BUSH QTY [ ] [ 35 ]	WASHER QTY [ ] [ 36 ]	LOCKING WASHER QTY [ ] [ 37 ]	NUT QTY [ ] [ 39 ]	SWITCH ASSY QTY 1 [ 45 ]	SWITCH COIL ASSY QTY 1 [ 60 ]	MOVING PLATE ASSY QTY 1 [ 61 ]	CORE PLUG SPRING QTY 1 [ 63 ]	"O" RING QTY 2 [ 67 ]	MAIN CONTACT SPRING QTY 1 [ 91 ]	RESISTOR ASSY QTY 1 [ 110 ]
S115A-12-1	1327A011	6211-675E [1]	5587-183 [1]	5936-482D [1]	5244-22 [2]	NU11-3T1 [2]	6510-58	6510-64	6211-32	6211-479	6211-675K	5933-635	6211-46A
S115A-12-3M	1327A021	6211-675E [2]	5587-183 [2]	5936-482D [2]	5244-22 [4]	NU11-3T1 [4]	6510-59	6510-65	6211-189	6211-479	6211-675P	5933-635	6211-175A
S115A-12-3	1327A024	6211-675E [2]	5587-183 [2]	5936-482D [2]	5244-22 [4]	NU11-3T1 [4]	6510-59	6510-65	6211-189	6211-479	6211-675P	5933-635	6211-175A
S115A-12-4M	1327A031	6211-675E [1]	5587-183 [1]	5936-482D [1]	5244-22 [2]	NU11-3T1 [4]	6510-59	6510-65	6211-189	6211-478	6211-675P	5933-635	6211-175A
S115A-12-5	1327A041	6211-675E [1]	5587-183 [1]	5936-482D [1]	5244-22 [2]	NU11-3T1 [2]	6510-58	6510-64	6211-32	6211-478	6211-675K	5933-635	6211-46A
S115A-12-7	1327A051	6211-675E [1]	5587-183 [1]	5936-482D [1]	5244-22 [2]	NU11-3T1 [2]	6510-58	6510-64	6211-32	6211-478	6211-675K	5933-635	6211-46A
S115A-12-9	1327A061	6211-675E [1]	5587-183 [1]	5936-482D [1]	5244-22 [2]	NU11-3T1 [2]	6510-58	6510-64	6211-32	6211-478	6211-675K	5933-635	6211-46A
S115A-12-10	1327A071	6211-675E [1]	5587-183 [1]	5936-482D [1]	5244-22 [2]	NU11-3T1 [2]	6510-58	6510-64	6211-32	6211-478	6211-675K	5933-635	6211-46A
S115A-12-11M	1327A081	6211-675E [2]	5587-183 [2]	5936-482D [2]	5244-22 [4]	NU11-3T1 [4]	6510-59	6510-65	6211-189	6211-479	6211-675P	5933-635	6211-175A
S115A-12-12	1327A091	6211-675E [1]	5587-183 [1]	5936-482D [1]	5244-22 [2]	NU11-3T1 [2]	6510-58	6510-64	6211-32	6211-479	6211-675K	5933-635	6211-46A
S115A-12-13M	1327A101	6211-675E [2]	5587-183 [2]	5936-482D [2]	5244-22 [4]	NU11-3T1 [4]	6510-59	6510-65	6211-189	6211-479	6211-675P	5933-635	6211-175A
S115A-12-14	1327A111	6211-675E [1]	5587-183 [1]	5936-482D [1]	5244-22 [2]	NU11-3T1 [2]	6510-58	6510-64	6211-32	6211-479	6211-675K	5933-635	6211-46A
S115A-12-15M	1327A121	6211-675E [2]	5587-183 [2]	5936-482D [2]	5244-22 [4]	NU11-3T1 [4]	6510-59	6510-65	6211-189	6211-479	6211-675P	5933-635	6211-175A
S115A-12-30M	1327A141	6211-675E [2]	5587-183 [2]	5936-482D [2]	5244-22 [4]	NU11-3T1 [4]	6510-59	6510-65	6211-189	6211-478	6211-675P	5933-635	6211-175A

MODEL TYPE 24 VOLT	PART NO:	"O" RING SEAL QTY [ ] [ 34E ]	INSULATING BUSH QTY [ ] [ 35 ]	WASHER QTY [ ] [ 36 ]	LOCKING WASHER QTY [ ] [ 37 ]	NUT QTY [ ] [ 39 ]	SWITCH ASSY QTY 1 [ 45 ]	SWITCH COIL ASSY QTY 1 [ 60 ]	MOVING PLATE ASSY QTY 1 [ 61 ]	CORE PLUG SPRING QTY 1 [ 63 ]	"O" RING QTY 2 [ 67 ]	MAIN CONTACT SPRING QTY 1 [ 91 ]	RESISTOR ASSY QTY 1 [ 110 ]
S115A-24-1	1327A 411	6211-675E [1]	5587-183 [1]	5936-482D [1]	5244-22 [1]	NU11-3T1 [2]	6510-60	6510-66	6211-32	6211-479	6211-675K	5933-636	6510-79
S115A-24-2	1327A 421	6211-675E [1]	5587-183 [1]	5936-482D [1]	5244-22 [1]	NU11-3T1 [2]	6510-60	6510-66	6211-32	6211-479	6211-675K	5933-636	6510-79
S115A-24-3M	1327A 431	6211-675E [2]	5587-183 [2]	5936-482D [2]	5244-22 [2]	NU11-3T1 [4]	6510-56	6510-62	6211-32	6211-479	6211-675P	5933-636	6211-526
S115A-24-3	1327A 434	6211-675E [2]	5587-183 [2]	5936-482D [2]	5244-22 [2]	NU11-3T1 [4]	6510-56	6510-62	6211-32	6211-479	6211-675P	5933-636	6211-526
S115A-24-4M	1327A 441	6211-675E [2]	5587-183 [2]	5936-482D [2]	5244-22 [2]	NU11-3T1 [4]	6510-56	6510-62	6211-32	6211-478	6211-675P	5933-636	6211-526
S115A-24-5	1327A 451	6211-675E [1]	5587-183 [1]	5936-482D [1]	5244-22 [1]	NU11-3T1 [4]	6510-60	6510-66	6211-32	6211-478	6211-675K	5933-636	6510-79
S115A-24-6	1327A 461	6211-675E [2]	5587-183 [2]	5936-482D [2]	5244-22 [2]	NU11-3T1 [4]	6510-56	6510-62	6211-32	6211-479	6211-675P	5933-636	6211-526
S115A-24-7	1327A 471	6211-675E [1]	5587-183 [1]	5936-482D [1]	5244-22 [1]	NU11-3T1 [2]	6510-60	6510-66	6211-32	6211-478	6211-675K	5933-636	6510-79
S115A-24-8	1327A 481	6211-675E [2]	5587-183 [2]	5936-482D [2]	5244-22 [2]	NU11-3T1 [4]	6510-56	6510-62	6211-32	6211-479	6211-675P	5933-636	6211-526
S115A-24-9	1327A 491	6211-675E [1]	5587-183 [1]	5936-482D [1]	5244-22 [1]	NU11-3T1 [2]	6510-60	6510-66	6211-32	6211-478	6211-675K	5933-636	6510-79
S115A-24-11M	1327A 501	6211-675E [2]	5587-183 [2]	5936-482D [2]	5244-22 [2]	NU11-3T1 [4]	6510-56	6510-62	6211-32	6211-479	6211-675P	5933-636	6211-526
S115A-24-12	1327A 511	6211-675E [1]	5587-183 [1]	5936-482D [1]	5244-22 [1]	NU11-3T1 [2]	6510-60	6510-66	6211-32	6211-479	6211-675K	5933-636	6510-79
S115A-24-13M	1327A 521	6211-675E [2]	5587-183 [2]	5936-482D [2]	5244-22 [2]	NU11-3T1 [4]	6510-56	6510-62	6211-32	6211-479	6211-675P	5933-636	6211-526
S115A-24-14	1327A 531	6211-675E [1]	5587-183 [1]	5936-482D [1]	5244-22 [1]	NU11-3T1 [2]	6510-60	6510-66	6211-32	6211-479	6211-675K	5933-636	6510-79
S115A-24-15M	1327A 541	6211-675E [2]	5587-183 [2]	5936-482D [2]	5244-22 [2]	NU11-3T1 [4]	6510-56	6510-62	6211-32	6211-479	6211-675P	5933-636	6211-526
S115A-24-16M	1327A 551	6211-675E [2]	5587-183 [2]	5936-482D [2]	5244-22 [2]	NU11-3T1 [4]	6510-56	6510-62	6211-32	6211-479	6211-675P	5933-636	6211-526
S115A-24-18	1327A 571	6211-675E [1]	5587-183 [1]	5936-482D [1]	5244-22 [1]	NU11-3T1 [2]	6510-60	6510-66	6211-32	6211-479	6211-675K	5933-636	6510-79
S115A-24-19	1327A 581	6211-675E [1]	5587-183 [1]	5936-482D [1]	5244-22 [1]	NU11-3T1 [2]	6510-60	6510-66	6211-32	6211-479	6211-675K	5933-636	6510-79
S115A-24-20	1327A 591	6211-675E [2]	5587-183 [2]	5936-482D [2]	5244-22 [2]	NU11-3T1 [4]	6510-56	6510-62	6211-32	6211-478	6211-675P	5933-636	6211-526
S115A-24-21	1327A 601	6211-675E [1]	5587-183 [1]	5936-482C [1]	5293-57 [1]	NU11-4T1 [2]	6510-60	6510-66	6211-32	6211-479	6211-675K	5933-636	6510-79
S115A-24-22	1327A 611	6211-675E [2]	5587-183 [2]	5936-482D [2]	5244-22 [2]	NU11-3T1 [4]	6510-56	6510-62	6211-32	6211-479	6211-675P	5933-636	6211-526
S115A-24-23	1327A 621	6211-675E [1]	5587-183 [1]	5936-482D [1]	5293-57 [1]	NU11-3T1 [2]	6510-60	6510-66	6211-32	6211-478	6211-675K	5933-636	6510-79
S115A-24-25	1327A 641	6211-675E [1]	5587-183 [1]	5936-482C [1]	5293-57 [1]	NU11-4T1 [2]	6510-60	6510-66	6211-32	6211-479	6211-675K	5933-636	6510-79
S115A-24-27	1327A 661	6211-675E [1]	5587-183 [1]	5936-482C [1]	5293-57 [1]	NU11-4T1 [2]	6510-61	6510-66	6211-32	6211-479	6211-675P	5933-636	6510-79
S115A-24-28	1327A 671	6211-675E [1]	5587-183 [1]	5936-482C [1]	5293-57 [1]	NU11-4T1 [2]	6510-60	6510-66	6211-32	6211-479	6211-675K	5933-636	6510-79
S115A-24-29	1327A 681	6211-675E [1]	5587-183 [1]	5936-482C [1]	5293-57 [1]	NU11-4T1 [2]	6510-60	6510-66	6211-32	6211-479	6211-675K	5933-636	6510-79
S115A-24-30M	1327A 691	6211-675E [2]	5587-183 [2]	5936-482D [2]	5244-22 [2]	NU11-3T1 [4]	6510-56	6510-62	6211-32	6211-478	6211-675P	5933-636	6211-526
S115A-24-32	1327A 700	6211-675E [1]	5587-183 [1]	5936-482D [1]	5244-22 [1]	NU11-3T1 [2]	6510-60	6510-66	6211-32	6211-479	6211-675K	5933-636	6510-79
S115A-24-33	1327A 710	6211-675E [1]	5587-183 [1]	5936-482D [1]	5244-22 [1]	NU11-3T1 [2]	6510-60	6510-66	6211-32	6211-479	6211-675K	5933-636	6510-79

## S115A STARTER MOTOR SERIES

MODEL TYPE 12 VOLT	PART NO:	LINK QTY 1 [ 97 ]	SPACER QTY 1 [ 124 ]	INSULATION BUSH QTY 1 [ 125 ]	RIVET QTY 1 [ 126 ]	DUST COVER QTY 1 [ 133 ]	RETURN SPRING QTY 1 [ 134 ]	THRUST WASHER QTY [   ] [ 136 ]	THRUST WASHER QTY [   ] [ 136A ]	STOP NUT QTY 1 [ 137 ]	DUST CAP QTY 1 [ 138 ]	ARMATURE ASSY QTY 1 [ 140 ]	FIELD COIL SET QTY 1 [ 191 ]
		NOTE 1											
S115A-12-1	1327A011	-	5933-287	5587-117	5336-257A	6265-703	6211-227A	6265-705 [1]	6265-705A [1]	5330-525	6265-704	6332-A1413	6211-289A
S115A-12-3M	1327A021	6211-188	5933-287	5587-117	5336-257A	6265-703	6211-227A	6265-705 [1]	6265-705A [1]	5330-525	6265-704	6332-A1442	6333-F844
S115A-12-3	1327A024	6211-188	5933-287	5587-117	5336-257A	6265-703	6211-227A	6265-705 [1]	6265-705A [1]	5330-525	6265-704	6332-A1413	6211-289A
S115A-12-4M	1327A031	6211-188	5933-287	5587-117	5336-257A	6265-703	6211-227A	6265-705 [1]	6265-705A [1]	5330-525	6265-704	6332-A1442	6333-F844
S115A-12-5	1327A041	-	5933-287	5587-117	5336-257A	6265-703	6211-227A	6265-705 [1]	6265-705A [1]	5330-525	6265-704	6332-A1413	6211-289A
S115A-12-7	1327A051	-	5933-287	5587-117	5336-257A	6265-703	6211-227A	6265-705 [1]	6265-705A [1]	5330-525	6265-704	6332-A1413	6211-289A
S115A-12-9	1327A061	-	5933-287	5587-117	5336-257A	-	6211-227A	6265-705 [2]	-	5330-525	-	6332-A1413	6211-289A
S115A-12-10	1327A071	-	5933-287	5587-117	5336-257A	6265-703	6211-227A	6265-705 [1]	6265-705A [1]	5330-525	6265-704	6332-A1460	6211-289A
S115A-12-11M	1327A081	6211-188	5933-287	5587-117	5336-257A	-	6211-761	6265-710 [2]	-	5330-539	-	6332-A1442	6333-F844
S115A-12-12	1327A091	-	5933-287	5587-117	5336-257A	6265-703	6211-227A	6265-705 [1]	6265-705A [1]	5330-525	6265-704	6332-A1460	6211-289A
S115A-12-13M	1327A101	6211-188	5933-287	5587-117	5336-257A	6265-703	6211-227	6265-705 [1]	6265-705A [1]	5330-525A	6265-704	6332-A1448	6333-F845
S115A-12-14	1327A111	-	5933-287	5587-117	5336-257A	6265-703	6211-227A	6265-705 [1]	6265-705A [1]	5330-525	6265-704	6332-A1413	6211-289A
S115A-12-15M	1327A121	6211-188	5933-287	5587-117	5336-257A	6265-703	6211-227A	6265-705 [1]	6265-705A [1]	5330-525	6265-704	6332-A1442	6333-F844
S115A-12-30M	1327A141	6211-188	5933-287	5587-117	5336-257A	-	6211-591	-	-	5330-505	-	6332-A1442	6333-F844

MODEL TYPE 24 VOLT	PART NO:	INSULATION "H" WASHER QTY 1 [ 122 ]	INSULATION WASHER QTY 2 [ 123 ]	RIVET QTY 1 [ 126 ]	DUST COVER QTY 1 [ 133 ]	RETURN SPRING QTY 1 [ 134 ]	THRUST WASHER QTY [   ] [ 136 ]	THRUST WASHER QTY [   ] [ 136A ]	STOP NUT QTY 1 [ 137 ]	DUST CAP QTY 1 [ 138 ]	INNER COVER QTY 1 [ 139 ]	ARMATURE ASSY QTY 1 [ 140 ]	FIELD COIL SET QTY 1 [ 191 ]
S115A-24-1	1327A 411	6510-84	5936-374	5336-372	6265-703	6211-227A	6265-705 [1]	6265-705A [1]	5330-525	6265-704	-	6332-A1437	5933-602F
S115A-24-2	1327A 421	6510-84	5936-374	5336-372	6265-703	6211-227A	6265-705 [1]	6265-705A [1]	5330-525	6265-704	-	6332-A1437	5933-602F
S115A-24-3M	1327A 431	6510-84	5936-374	5336-372	6265-703	6211-227A	6265-705 [1]	6265-705A [1]	5330-525	6265-704	-	6332-A1441	5933-602G
S115A-24-3	1327A 434	6510-84	5936-374	5336-372	6265-703	6211-227A	6265-705 [1]	6265-705A [1]	5330-525	6265-704	-	6332-A1437	5933-602F
S115A-24-4M	1327A 441	6510-84	5936-374	5336-372	6265-703	6211-227A	6265-705 [1]	6265-705A [1]	5330-525	6265-704	-	6332-A1441	5933-602G
S115A-24-5	1327A 451	6510-84	5936-374	5336-372	6265-703	6211-227A	6265-705 [1]	6265-705A [1]	5330-525	6265-704	-	6332-A1437	5933-602F
S115A-24-6	1327A 461	6510-84	5936-374	5336-372	6265-703	6211-227A	6265-705 [1]	6265-705A [1]	5330-525	6265-704	-	6332-A1437	5933-602F
S115A-24-7	1327A 471	6510-84	5936-374	5336-372	6265-703	6211-227A	6265-705 [1]	6265-705A [1]	5330-525	6265-704	-	6332-A1437	5933-602F
S115A-24-8	1327A 481	6510-84	5936-374	5336-372	6265-703	6211-227A	6265-705 [1]	6265-705A [1]	5330-525	6265-704	-	6332-A1437	5933-602F
S115A-24-9	1327A 491	6510-84	5936-374	5336-372	-	6211-227A	6265-705 [2]	-	5330-525	-	-	6332-A1437	5933-602F
S115A-24-11M	1327A 501	6510-84	5936-374	5336-372	-	6211-761	6265-710 [2]	-	5330-539	-	-	6332-A1441	5933-602G
S115A-24-12	1327A 511	6510-84	5936-374	5336-372	6265-703	6211-227A	6265-705 [1]	6265-705A [1]	5330-525	6265-704	-	6332-A1449	5933-602F
S115A-24-13M	1327A 521	6510-84	5936-374	5336-372	6265-703	6211-227	6265-705 [1]	6265-705A [1]	5330-525A	6265-704	-	6332-A1446	6211-173
S115A-24-14	1327A 531	6510-84	5936-374	5336-372	6265-703	6211-227A	6265-705 [1]	6265-705A [1]	5330-525	6265-704	-	6332-A1437	5933-602F
S115A-24-15M	1327A 541	6510-84	5936-374	5336-372	6265-703	6211-227A	6265-705 [1]	6265-705A [1]	5330-525	6265-704	-	6332-A1441	5933-602G
S115A-24-16M	1327A 551	6510-84	5936-374	5336-372	6265-703	6211-227A	6265-705 [1]	6265-705A [1]	5330-525	6265-704	-	6332-A1441	5933-602G
S115A-24-18	1327A 571	6510-84	5936-374	5336-372	-	6211-761	6265-710 [2]	-	5330-539	-	-	6332-A1449	5933-602F
S115A-24-19	1327A 581	6510-84	5936-374	5336-372	6265-703	6211-227A	6265-705 [1]	6265-705A [1]	5330-525	6265-704	-	6332-A1437	5933-602F
S115A-24-20	1327A 591	6510-84	5936-374	5336-372	6265-703	6211-227A	6265-705 [1]	6265-705A [1]	5330-525	6265-704	-	6332-A1437	5933-602F
S115A-24-21	1327A 601	6510-84	5936-374	5336-372	-	6211-70A	6265-705 [2]	-	5330-517D	-	-	6332-A1455	5933-602F
S115A-24-22	1327A 611	6510-84	5936-374	5336-372	6265-703	6211-227A	6265-705 [1]	6265-705A [1]	5330-525	6265-704	-	6332-A1437	5933-602F
S115A-24-23	1327A 621	6510-84	5936-374	5336-372	6265-703	6211-227A	6265-705 [1]	6265-705A [1]	5330-525	6265-704	-	6332-A1449	5933-602F
S115A-24-25	1327A 641	6510-84	5936-374	5336-372	6265-703	6211-227A	6265-705 [1]	6265-705A [1]	5330-525	6265-704	-	6332-A1455	5933-602F
S115A-24-27	1327A 661	6510-84	5936-374	5336-372	6265-703	6211-227A	6265-705 [1]	6265-705A [1]	5330-525	6265-704	-	6332-A1437	5933-602F
S115A-24-28	1327A 671	6510-84	5936-374	5336-372	6265-703	6211-227A	6265-705 [1]	6265-705A [1]	5330-525	6265-704	-	6332-A1455	5933-602F
S115A-24-29	1327A 681	6510-84	5936-374	5336-372	6211-858A	6211-860A	5936-491 [1]	5936-491A [2]	5330-543A	6211-861	6211-857A	6332-A1455	5933-602F
S115A-24-30M	1327A 691	6510-84	5936-374	5336-372	-	6211-591	-	-	5330-505	-	-	6332-A1441	5933-602G
S115A-24-32	1327A 700	6510-84	5936-374	5336-372	6265-703	6211-227A	6265-705 [1]	6265-705A [1]	5330-525	6265-704	-	6332-A1437	5933-602F
S115A-24-33	1327A 710	6510-84	5936-374	5336-372	6265-670B	6211-227A	6265-705 [2]	-	5330-525	6265-671B	-	6332-A1437	5933-602F

## S115A STARTER MOTOR SERIES

MODEL TYPE 12 VOLT	PART NO:	FIELD RING ASSY. QTY 1 [ 194 ]	CAP QTY 1 [ 195 ]	LEAD SUPPORT QTY 1 [ 200 ]	C.E. HOUSING ASSY, QTY 1 [ 225 ]	BRUSH PLATE ASSY. QTY 1 [ 240 ]	BRUSH SPRING [ 253 ] QTY 4	BRUSH QTY 4 [ 280 ]	WASHER QTY 1 [ 299 ]	WASHER QTY 1 [ 300 ]	SPRING WASHER QTY 2 [ 301 ]	HEX NUT QTY 2 [ 302 ]	WASHER QTY 1 [ 311 ]
		NOTE 2			NOTE 3	NOTE 4	NOTE 4						
S115A-12-1	1327A011	6211-793	-	-	6211-952	6510-81	5933-336	6211-548A	5936-490	5936-495L	5001-74	NU11-5T1	5936-490
S115A-12-3M	1327A021	6211-793A	6211-782	-	6211-952	6510-83	5933-336	6211-548A	5936-129D	5936-495L	5001-74	NU11-5T1	5936-129C
S115A-12-3	1327A024	6211-793	6211-782	-	6211-952	6510-81A	5933-336	6211-548A	5936-129D	5936-495L	5001-74	NU11-5T1	5936-129C
S115A-12-4M	1327A031	6211-793A	6211-782	-	6211-952	6510-83	5933-336	6211-548A	5936-129D	5936-495L	5001-74	NU11-5T1	5936-129C
S115A-12-5	1327A041	6211-793	-	-	6211-952	6510-81	5933-336	6211-548A	5936-490	5936-495L	5001-74	NU11-5T1	5936-490
S115A-12-7	1327A051	6211-793	-	-	6211-952	6510-81	5933-336	6211-548A	5936-490	5936-495L	5001-74	NU11-5T1	5936-490
S115A-12-9	1327A061	6211-793	-	-	6211-952	6510-81	5933-336	6211-548A	5936-490	5936-495L	5001-74	NU11-5T1	5936-490
S115A-12-10	1327A071	6211-793	-	-	6211-952	6510-81	5933-336	6211-548A	5936-490	5936-495L	5001-74	NU11-5T1	5936-490
S115A-12-11M	1327A081	6211-793A	6211-782	-	6211-952	6510-83A	5933-336	6211-548A	5936-129D	5936-495L	5001-31	NU11-6T1	5936-129C
S115A-12-12	1327A091	6211-793	-	-	6211-952	6510-81	5933-336	6211-548A	5936-490	5936-495L	5001-74	NU11-5T1	5936-490
S115A-12-13M	1327A101	6211-793B	6211-782	-	6211-952A	6510-82	5933-336	6211-548A	5936-129D	5936-495L	5001-74	NU11-5T1	5936-129C
S115A-12-14	1327A111	6211-793	-	-	6211-952	6510-81	5933-336	6211-548A	5936-490	5936-495L	5001-74	NU11-5T1	5936-490
S115A-12-15M	1327A121	6211-793A	6211-782	-	6211-952	6510-83	5933-336	6211-548A	5936-129D	5936-495L	5001-74	NU11-5T1	5936-129C
S115A-12-30M	1327A141	6211-793A	6211-782	-	6211-952	6510-83	5933-336	6211-548A	5936-129D	5936-495L	5001-74	NU11-5T1	5936-129C

MODEL TYPE 24 VOLT	PART NO:	FIELD RING ASSY. QTY 1 [ 194 ]	CAP QTY 1 [ 195 ]	LEAD SUPPORT QTY 1 [ 200 ]	C.E. HOUSING ASSY, QTY 1 [ 225 ]	BRUSH PLATE ASSY. QTY 1 [ 240 ]	BRUSH SPRING [ 253 ] QTY 4	BRUSH QTY 4 [ 280 ]	WASHER QTY 1 [ 299 ]	WASHER QTY 1 [ 300 ]	SPRING WASHER QTY 2 [ 301 ]	HEX NUT QTY 2 [ 302 ]	WASHER QTY 1 [ 311 ]
		NOTE 2			NOTE 3	NOTE 4	NOTE 4						
S115A-24-1	1327A 411	6211-957A	-	-	6211-952	6510-80B	5933-336	6211-548	5936-490	5936-495L	5001-74	NU11-5T1	5936-490
S115A-24-2	1327A 421	6211-957A	-	-	6211-952	6510-80B	5933-336	6211-548	5936-490	5936-495L	5001-74	NU11-5T1	5936-490
S115A-24-3M	1327A 431	6211-957C	6211-782	-	6211-952	6510-82	5933-336	6211-548	5936-129D	5936-495L	5001-74	NU11-5T1	5936-129C
S115A-24-3	1327A 434	6211-957A	6211-782	-	6211-952	6510-80A	5933-336	6211-548	5936-129D	5936-495L	5001-74	NU11-5T1	5936-129C
S115A-24-4M	1327A 441	6211-957C	6211-782	-	6211-952	6510-82	5933-336	6211-548	5936-129D	5936-495L	5001-74	NU11-5T1	5936-129C
S115A-24-5	1327A 451	6211-957A	-	-	6211-952	6510-80B	5933-336	6211-548	5936-490	5936-495L	5001-74	NU11-5T1	5936-490
S115A-24-6	1327A 461	6211-957A	6211-782	-	6211-952	6510-80A	5933-336	6211-548	5936-129D	5936-495L	5001-74	NU11-5T1	5936-129C
S115A-24-7	1327A 471	6211-957A	-	-	6211-952	6510-80B	5933-336	6211-548	5936-490	5936-495L	5001-74	NU11-5T1	5936-490
S115A-24-8	1327A 481	6211-957A	6211-782	-	6211-952	6510-80A	5933-336	6211-548	5936-129D	5936-495L	5001-74	NU11-5T1	5936-129C
S115A-24-9	1327A 491	6211-957A	-	-	6211-952	6510-80A	5933-336	6211-548	5936-490	5936-495L	5001-74	NU11-5T1	5936-490
S115A-24-11M	1327A 501	6211-957C	6211-782	-	6211-952	6510-82A	5933-336	6211-548	5936-129D	5936-495L	5001-31	NU11-6T1	5936-129C
S115A-24-12	1327A 511	6211-957A	-	-	6211-952	6510-80B	5933-336	6211-548	5936-490	5936-495L	5001-74	NU11-5T1	5936-490
S115A-24-13M	1327A 521	6211-752B	6211-782	-	6211-952A	6510-83	5933-336	6211-548	5936-129D	5936-495L	5001-74	NU11-5T1	5936-129C
S115A-24-14	1327A 531	6211-957A	-	-	6211-952	6510-80B	5933-336	6211-548	5936-490	5936-495L	5001-74	NU11-5T1	5936-490
S115A-24-15M	1327A 541	6211-957C	6211-782	-	6211-952	6510-82	5933-336	6211-548	5936-129D	5936-495L	5001-74	NU11-5T1	5936-129C
S115A-24-16M	1327A 551	6211-957C	6211-782	6211-503	6211-952	6510-82	5933-336	6211-548	5936-129D	5936-495L	5001-74	NU11-5T1	5936-129C
S115A-24-18	1327A 571	6211-957A	-	-	6211-952	6510-80B	5933-336	6211-548	5936-490	5936-495L	5001-74	NU11-5T1	5936-490
S115A-24-19	1327A 581	6211-957A	-	-	6211-952	6510-80B	5933-336	6211-548	5936-490	5936-495L	5001-74	NU11-5T1	5936-490
S115A-24-20	1327A 591	6211-957A	6211-782	-	6211-952	6510-80A	5933-336	6211-548	5936-129D	5936-495L	5001-74	NU11-5T1	5936-129C
S115A-24-21	1327A 601	6211-957A	-	-	6211-952	6510-80	6265-103A	6211-548	5936-490	-	5001-26	NU11-7T1	5936-490
S115A-24-22	1327A 611	6211-957A	6211-782	-	6211-952	6510-80A	5933-336	6211-548	5936-129D	5936-495L	5001-74	NU11-5T1	5936-129C
S115A-24-23	1327A 621	6211-957A	-	-	6211-952	6510-80B	5933-336	6211-548	5936-490	-	5001-74	NU11-5T1	5936-490
S115A-24-25	1327A 641	6211-957A	-	-	6211-952	6510-80	6265-103A	6211-548B	5936-490	-	5001-26	NU11-7T1	5936-490
S115A-24-27	1327A 661	6211-957A	6211-782	6211-503	6211-952	6510-80C	5933-336	6211-548B	5936-129D	-	5001-74	NU11-5T1	5936-129C
S115A-24-28	1327A 671	6211-957A	-	-	6211-952	6510-80	6265-103A	6211-548B	5936-490	-	5001-26	NU11-7T1	5936-490
S115A-24-29	1327A 681	6211-957A	-	-	6211-952	6510-80	6265-103A	6211-548B	5936-129D	-	5001-26	NU11-7T1	5936-129C
S115A-24-30M	1327A 691	6211-957C	6211-782	-	6211-952	6510-82	5933-336	6211-548	5936-129D	5936-495L	5001-74	NU11-5T1	5936-129C
S115A-24-32	1327A 700	6211-752	-	-	6211-952	6510-80B	5933-336	6211-548	5936-490	5936-495L	5001-74	NU11-5T1	5936-490
S115A-24-33	1327A 710	6211-957A	-	-	6211-952	6510-80B	5933-336	6211-548	5936-129D	5936-495L	5001-74	NU11-5T1	5936-129C

## S115A STARTER MOTOR SERIES

COMMON PARTS							
REF. NO:	PART NO:	QTY	DESCRIPTION	REF. NO:	PART NO:	QTY	DESCRIPTION
5	NC7-17	12	BALL	129	5936-456	1	WASHER
9	6211-391	1	OIL SEAL	130	6211-600	1	TRIP PLATE
11	5549-608	1	RETAINING PAD	131	NM1-9	1	EXTERNAL CIRCLIP
12	6211-703	1	OIL PAD	132	6211-648	1	PLUG
13	6211-235	1	BEARING BUSH	132A	5855-30DV	1	SEALING RING
22	6211-675N	1	SEALING RING	188	6211-660	2	SEALING RING
31	5587-192A	1	OUTER INSULATOR	189	6211-662	1	DOWEL
34	6211-821	1	INSULATING BUSH	190	5333-190	4	POLE SCREW
59	6510-68	1	FIXED CONTACT ASSY	192	6211-708	1	FIELD RING
62	6211-500	1	CORE PLUG	193	6211-816	4	POLE PIECE
64	6211-727A	1	FELT PAD	229	6211-726	1	BEARING BUSH
65	6510-9	1	CAPTIVE SCREW & WASHER	254	6211-896	1	BALANCE LEAD
66	5587-181A	2	INSULATION BUSH	270A	NW1-70	A.R.	WASHER
68	5936-495L	1	WASHER	270B	NW1-69	A.R.	WASHER
69	5001-74	1	SPRING WASHER	270C	5936-163	A.R.	WASHER
70	5933-520	1	STOP	271	6211-367	1	INTERNAL CIRCLIP
71	5336-255	3	RIVET	272	5933-509	1	SPRING
81	5587-193	1	INNER INSULATOR	273	NC7-7	1	STEEL BALL
84	6211-961	4	SEGMENT	274	6211-369	1	BALL PAD
85	6211-385	1	SEGMENT SPRING	276	5335-960	2	SELF TAP SCREW
86	6211-879	1	PLUNGER	277	5001-48	2	LOCKING WASHER
92	6211-666	1	TRIGGER GUIDE	278	6211-675M	1	"O" RING SEAL
93	6211-671	1	SPRING & TRIGGER ASSY	279	6211-737	1	RECOIL CAP
98	5244-22	1	LOCKING WASHER	285	5335-973	4	SCREW
99	5334-325	1	HEX HD SCREW	286	6211-675B	2	"O" RING SEAL
100	6211-468	1	CONTACT RETURN SPRING	286A	5936-486	2	TAB WASHER
101	NW2-28Z1	2	WASHER	287	6211-738	2	THROUGH BOLT
102	5334-325	1	HEX NUT	313	NU11-5T1	1	HEX NUT
104	5335-973	2	SCREW				
106	6211-976	2	HEX SCREW WITH CAPTIVE WASHERS				
123A	6211-675D	1	SEALING RING				
123B	5936-482	1	WASHER				
127	6211-372	1	COLLAR				
128	6211-437	1	SPRING				

**NOTE 1 - LINK [ ITEM 97 ] IS SUPPLIED WITH SWITCH ASSY [ ITEM 45 ]**

**NOTE 2 - FIELD RING ASSY [ ITEM 194 ] COMPRISES ITEMS 189, 190, 191, 192 & 193**

**NOTE 3 - C.E.HOUSING ASSY [ ITEM 225 ] INCLUDES FITTED BUSH ITEM 229**

**NOTE 4 - BRUSH PLATE ASSY [ ITEM 240 ] INCLUDES BRUSH SPRINGS ITEM 253**

**NOTE 5 - MODEL TYPES S115A-12-13M AND S115A-24-13M ARE ANTI-CLOCKWISE ROTATION**

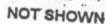

## S115A SERIES STARTER MOTOR

**SHEET 1 OF 2**

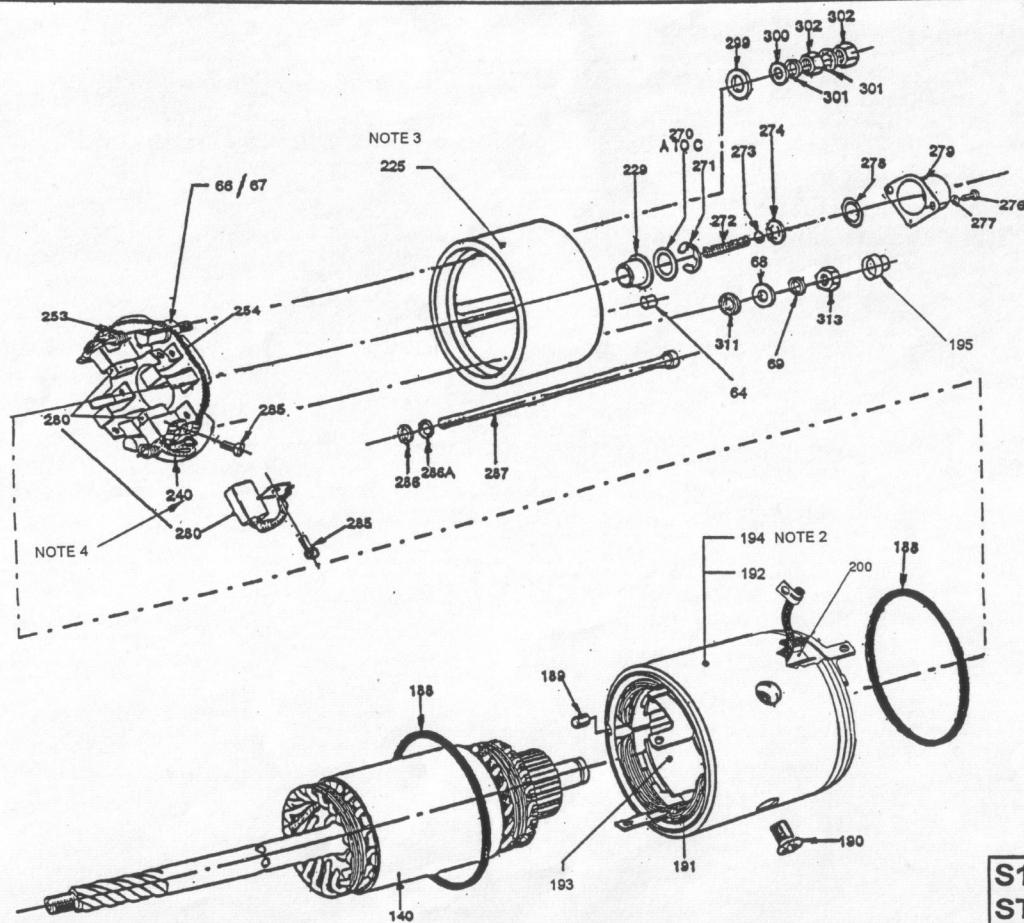

**S115A SERIES  
STARTER MOTOR**